

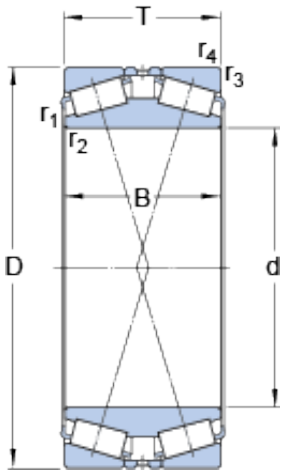

# BEARING MANUFACTURING DE MEXICO, S.A.D...



406.4 mm x 546.1 mm x 138.113 mm SKF BT2B  
331840 G/HA1C150 tapered roller bearings

Bearing No. BT2B 331840 G/HA1C150

BT2B 331840 G/HA1C150 Bearing 2D drawings and 3D  
CAD models

Size	546.1x406.4x138.113 mm
Bore Diameter	546,1 mm
Outer Diameter	406,4 mm
Width	138,113 mm
d	406.4 mm
D	546.1 mm
T	138.113 mm
B	138.113 mm
$r_{1,2}$ - min.	1.5 mm
$r_{3,4}$ - min.	6.4 mm
Basic dynamic load rating - C	2200 kN
Basic static load rating - $C_0$	5100 kN
Fatigue load limit - $P_u$	405 kN
Comparative radial load rating - $C_F$	540 kN
Comparative axial load rating - $C_{Fa}$	252 kN
Thrust factor - K	1.23
Calculation factor - e	0.48
Calculation factor - $Y_1$	1.4
Calculation factor - $Y_2$	2.1
Calculation factor - $Y_0$	1.4
Mass bearing	89 kg
Design variant/feature	TDI/GWIY2



## BEARING MANUFACTURING DE MEXICO,S.A.D...

$d_1$	435 mm
$D_1$	491 mm
$r_{1,2}$ min.	1.5 mm
$r_{3,4}$ min.	6.4 mm
Basic dynamic load rating C	2200 kN
Basic static load rating $C_0$	5100 kN
Fatigue load limit $P_u$	405 kN
Calculation factor e	0.48
Calculation factor $Y_1$	1.4
Calculation factor $Y_2$	2.1
Calculation factor $Y_0$	1.4
Comparative radial load rating $C_F$	540 kN
Comparative axial load rating $C_{Fa}$	252 kN
Thrust factor K	1.23