

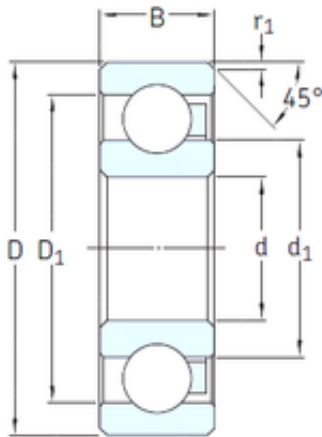

BEARING MANUFACTURING DE MEXICO, S.A.D...



25 mm x 47 mm x 12 mm SKF 6005/HR22T2
deep groove ball bearings

Bearing No. 6005/HR22T2

6005/HR22T2 Bearing 2D drawings and 3D CAD models

Size	25x47x12 mm
Bore Diameter	25 mm
Outer Diameter	47 mm
Width	12 mm
d	25 mm
D	47 mm
B	12 mm
C	12 mm
d1	32,2 mm
r1 min.	0,9 mm
D1	39,8 mm
Weight	0,0195 Kg
Basic dynamic load rating (C)	0,25 kN
Basic static load rating (C0)	0,19 kN
Category	Single Row Ball Bearings
Inventory	0.0
Manufacturer Name	SKF
Minimum Buy Quantity	N/A
Weight / Kilogram	0.076
Product Group	B00308
Enclosure	Open
Precision Class	ABEC 1 ISO P0
Maximum Capacity / Filling Slot	No
Rolling Element	Ball Bearing



BEARING MANUFACTURING DE MEXICO, S.A.D...

Snap Ring	No
Internal Special Features	No
Cage Material	Polypropylene
Internal Clearance	C0-Medium
Inch - Metric	Metric
Long Description	25MM Bore; 47MM Outside Diameter; 12MM Outer Race Width; Open; Ball Bearing; ABEC 1 ISO P0; No Filling Slot; No Snap Ring; No Internal Special Features; C0-Medium Internal Clearance; Polypropylene C
Other Features	Deep Groove Polymer Ball Bearing Polypropylene Inner Ring and Outer Ring Stainless Steel
Category	Single Row Ball Bearing
UNSPSC	31171504
Harmonized Tariff Code	8482.10.50.68
Noun	Bearing
Keyword String	Ball
Manufacturer URL	http://www.skf.com
Weight / LBS	0.078
Outside Diameter	1.85 Inch 47 Millimeter
Bore	0.984 Inch 25 Millimeter
Inner Race Width	0 Inch 0 Millimeter
Outer Race Width	0.472 Inch 12 Millimeter